

---

## LT probe - below 600°C

### Introduction

The CarboProbe LT is a **low temperature heated probe**, intended for use in flues and boilers where the temperature of the gases is below 600°C. It incorporates a heater to maintain the sensor at its working temperature, even if the gas is at a much lower temperature.

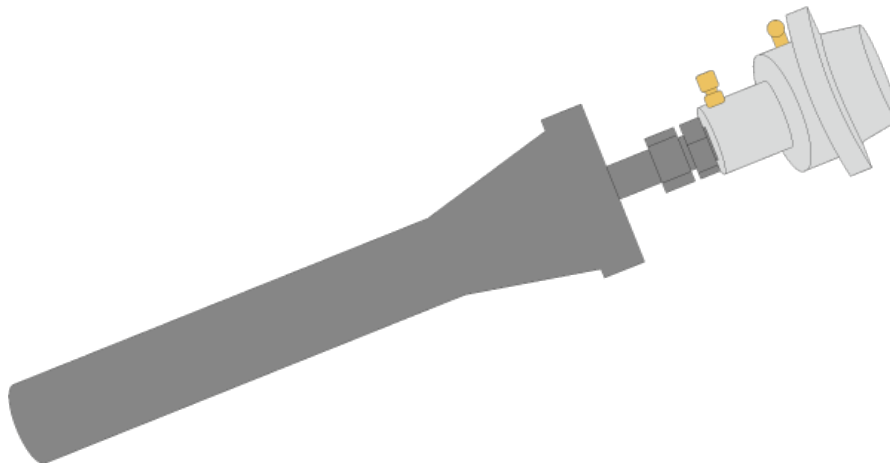

### Key features

- **Based on the ZRO<sub>2</sub> zirconium oxygen sensor.**
- Heater sealed in a stainless steel can, isolating it from corrosive flue gases.
- Porous filter in stainless steel to minimise dust build-up on the sensor.
- Gas inlet for calibration gases.
- Purge facility, to clean the filter in-situ.
- Modular construction for simple maintenance.
- Compact design (**diameter of 50mm**), allowing installation in small or large flues.
- Integrated K thermocouple, enabling accurate temperature control of the heater.

### Specifications

The LT probe requires a separate instrument panel providing power and temperature control for the heater, purge timing and purge gas.

**Don't hesitate to contact us for any further question you might have.**

If you think our LT probe is not the product you are looking for, we invite you to have a look at our website [www.econox.ch](http://www.econox.ch). There surely is a probe in our CarboProbe range that fits your need.

